

# SUNSTONE CABINET PACKAGE - THE CABANA

**Re-Configure how you like\***

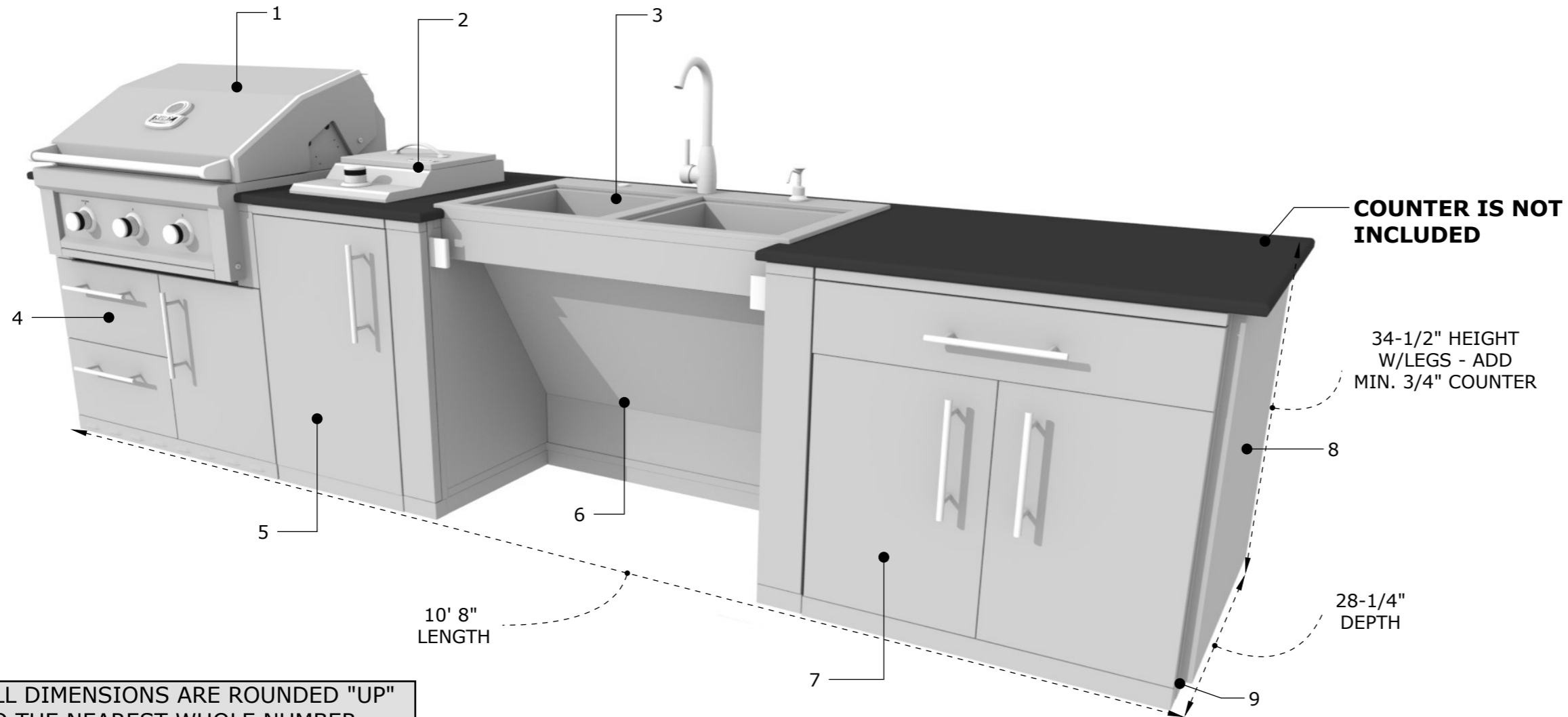

ALL DIMENSIONS ARE ROUNDED "UP" TO THE NEAREST WHOLE NUMBER

## Equipment List - See individual product Specification Sheets for more info.

ITEM	MODEL	DESCRIPTION	QTY.
1	RUBY3B	30" Ruby Series Gas grill - LP/NG	1
2	SUN13VSB	13" Ruby Series Versa Burner - LP/NG	1
3	ADASK37	37" ADA Compliant Double Sink	1
4	SAC34GLPCD	12" Spice Rack Cabinet	1
5	SBC18FSDL	18" Left Swing Full Height Base Cabinet	1
6	ADA44BC	44" ADA Compliant Sink Base Cabinet	1
7	SBC30CDD	30" Combo Double Door Base Cabinet	1
8	SCC27EP	27" Universal End Panel	2
9	SCC25KP	25" Universal Side Kickplate	2

**SUNSTONE METAL PRODUCTS**  
 16004 CENTRAL COMMERCE DR.  
 PFLUGERVILLE, TEXAS 78660  
 Tel: 888.934.9449  
 Bus: 512.487.5116  
 Fax: 512.487.7016

### PRODUCT

THE CABANA

**Item No.** SCPCABANA

### DESCRIPTION

The Cabana is 10 Feet 8 Inches expansive cabinet island configured as all ADA Compliant with commercial grade all 304 Stainless Steel and everything you need to complete your new outdoor kitchen. This configuration with Ruby Pro Sear Grill, Versa Single Burner & large ADA Compliant double sink. There is plenty of storage solutions with the large combo cabinet shelves below and full width drawer above, full height single door cabinet and door drawer combo below grill with space for a propane tank. With the ADA Compliant sink base cabinet you can pull your wheelchair right up into interior space with the included pull handles on either side bringing you right up to the front edge of sink basins for perfect access and within arm's reach to the faucet.

- 30" Gas Grill
- 13" Versa Side Burner
- 37" ADA Double Sink
- 34" Gas Grill Cabinet
- 18" Full Height Cabinet
- 44" ADA Sink Cabinet
- 30" Combo Drawer Cabinet
- All Hardware Included
- Front/Back Kick Plates
- Heavy-Duty Legs
- Counter Top Not Included

### Specifications

#### Package Size

Length measurement is rounded up to the nearest whole number  
 10' 8" Length (includes 2 x 1" End Panels) x 28-1/4"D (w/Doors) x 34-1/2"H (w/Legs) or 35-3/4"H (w/3/4" Counter)